

pennekamp 

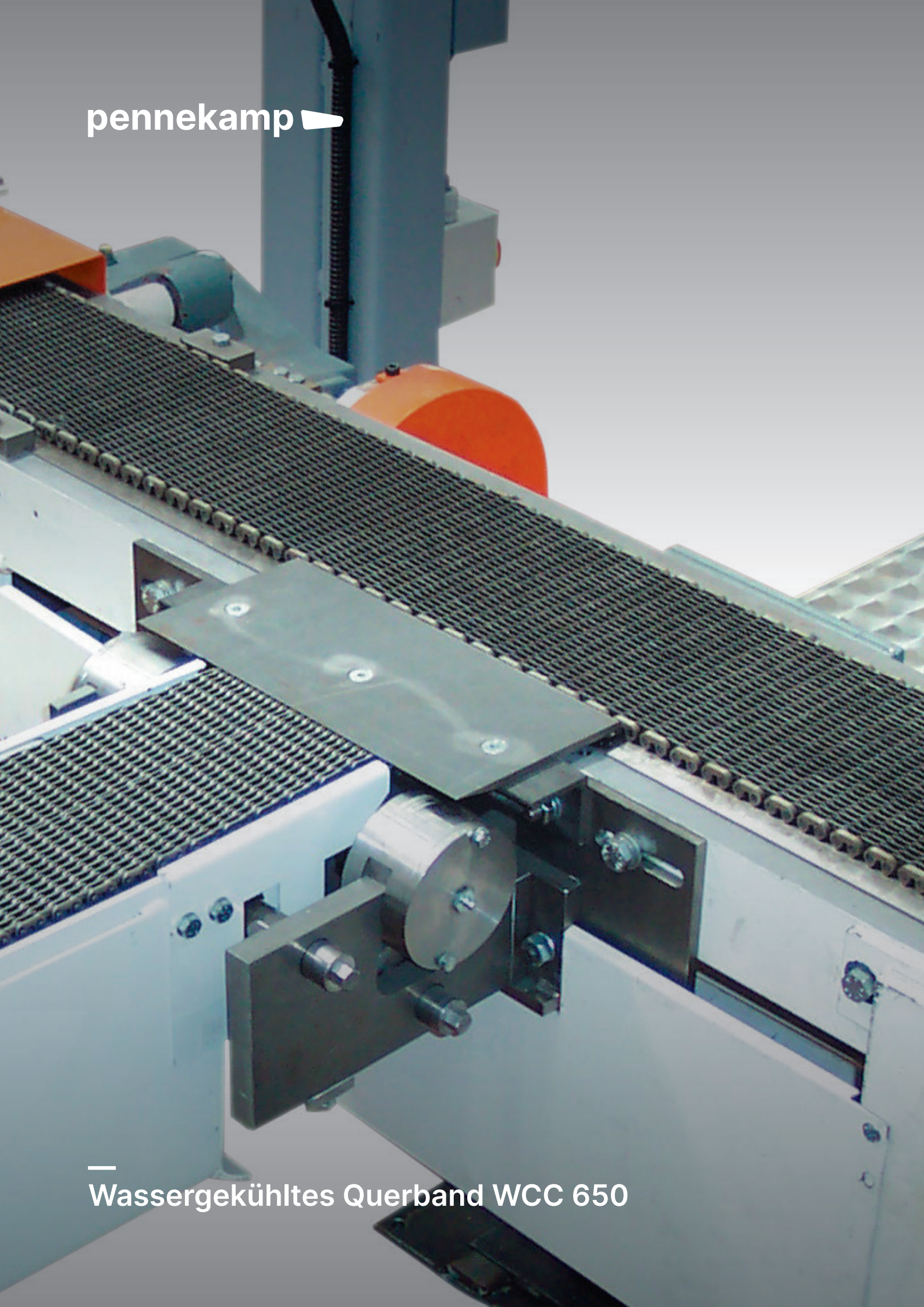

—
Wassergekühltes Querband WCC 650

Cross Conveyor

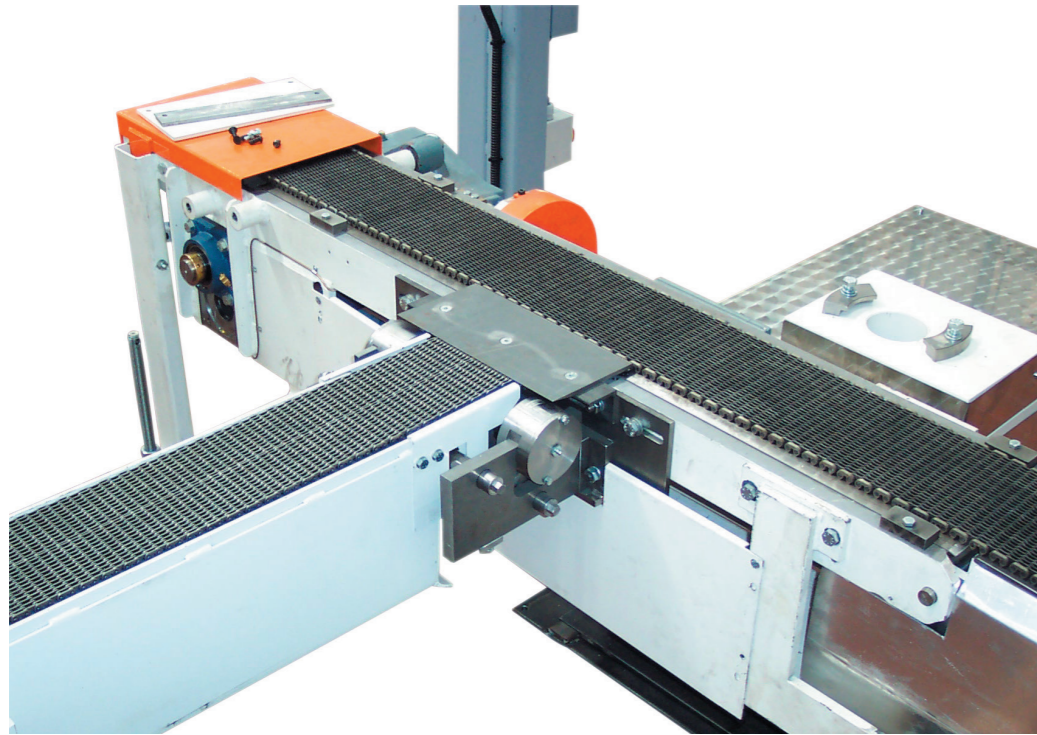

vertical axis, also during the production. The adjustment is made by use of eccentric devices and is absolutely required for trouble free operation conditions.

In order to basically adjust the height of the cross conveyor towards the lehr, adjustable feet are installed as well as eccentric devices for the fine tuning in the area of the conveyor supports. Those may also be leveled during the operation of the equipment. The scope of supply covers the transfer plates towards the lehr as well. Those are made from stainless steel and segmented in units of 300/400mm length. Each of these segments is adjustable in height towards the silent chain by use of two eccentric devices.

Belt brush for the optional use on Pennekamp Cross Conveyors

The automatic Pennekamp belt brush is designed for the installation on a Pennekamp cross conveyor, equipped with silent chains.

The belt brush is a compact and fully mechanical unit and may therefore be installed within the extension frame of the cross conveyor. No additional drive is required.

The entire unit is installed on the return of the existing cross conveyor. The silent chain will be back bent within the unit and brushed from below the glass contact side.

A fully automatic brush pressurization system will allow the correct pressure at any time at a maximum cleaning result and minimal wear. Below the brush, a draw is installed to collect and easily remove the remaining dirt and stain.

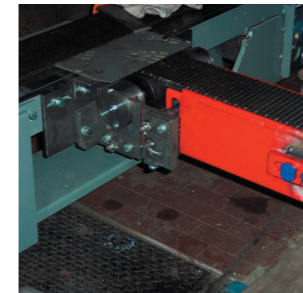

Return head
Special execution,
with use of a Pennekamp
ware transfer

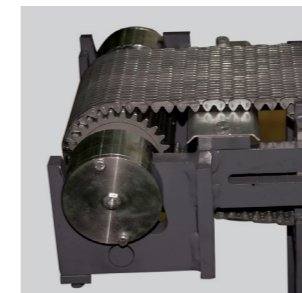

Return head
Standard execution

Water Cooled Cross Conveyor WCC 650

The cross conveyor is the connection between the glass forming and the lehr itself. It is installed in front of the lehr and transports the correctly spaced glass ware towards the lehr loading position. The water cooled cross conveyor is mainly used for wider applications to compensate the thermal bending and expansions so that the conveyor maintains absolutely straight. It is equipped with silent chain, drive station with required gear box, charge and return roller, chain support with wear strips, adjustment systems and transfer plates towards the lehr. The silent chains are available in various width and designs. Usually, the chain width is corresponding to the ware geometry at 125, 140 or 150mm width. Others are also available on request. The water cooled main beam is not in contact with the silent chain in order to withdraw heat from it. The water cooled main body allows maintaining the straight alignment of the conveyor itself. The silent chain supports are arranged in segments and allow the vertical alignment of the transfer plates.

The cross conveyor drive is manufactured according to the newest standards and equipped with a gravity chain tensioning system. The belt drive of the belt must be synchronized with the forming (IS) machine, whereas the drive motor itself is provided by the buyer. The specially designed return head which connects to the machine conveyor, has the ability to alter positioning and alignment of the return roller in horizontal and

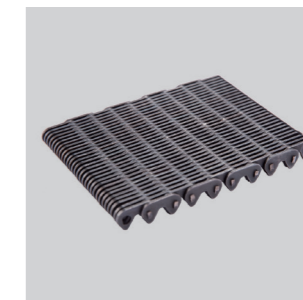
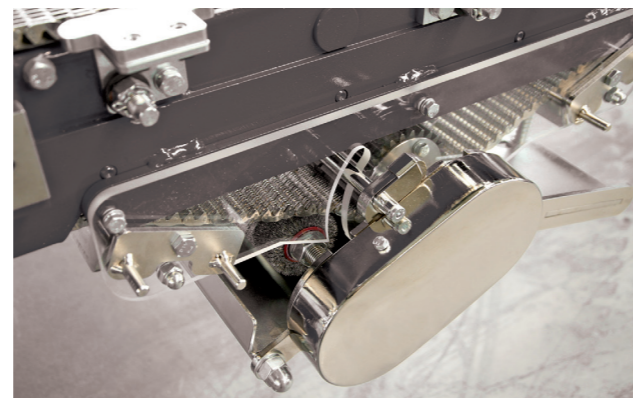

Narrow assembly
Used at small to medium diameters
(Cosmetical and Pharmaceutical)

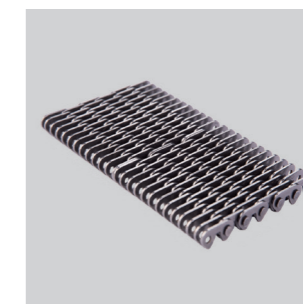

Loose assembly
Used for medium to large bottle diameters
(Beer, Soft-drink, Spirits)

Features

- Water cooled stainless steel design (main body)
- Complete drive station
(supply of drive motor by buyer)
- Automatic silent chain tensioning
- Thermal compensation
- Eccentric leveling device conveyor body (frame)
- Eccentric leveling device transfer plates
- Eccentric leveling device return head & roller
- Silent chain (100 – 150mm width, according to customer's demand)
- Wear plates under silent chain

Option:

- Belt brush
- Drive system with motor and synchronization

Water Cooled Cross Conveyor WCC 650

Belt width	A = 1.200 - 5.700mm
Silent Chain Width	100 - 300mm
Working height	700 - 1.070mm
Water Consumption	25l/min

Belt Cleaning Brush WCC 650

Length/Depth	A = 600mm
Width	D/E = 110mm
Height	B = 250mm
Working height	C = 100 - 300mm

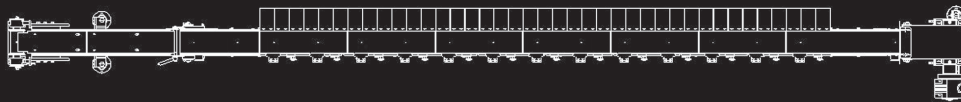
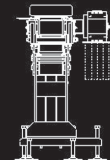
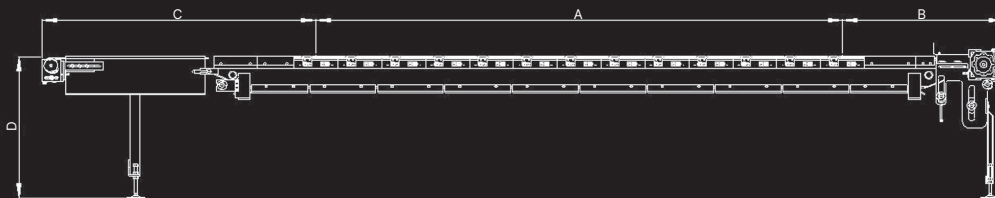
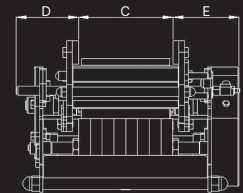
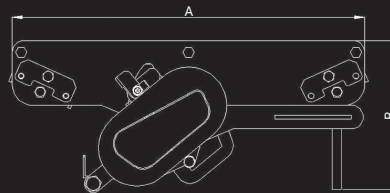
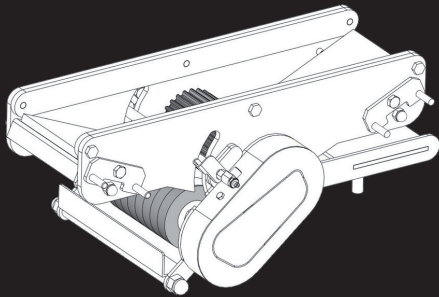

pennekamp 



Ernst Pennekamp GmbH & Co. OHG

Königsfelderstraße 38-42
D-58256 Ennepetal

T +49 (0) 23 33 605 - 0
info@pennekamp.de
www.pennekamp.de